

# Installation instructions for PZ4AL-01927-00, PZ4AL-01928-00 Under Run Protective Shield Fuel Tank

## LEXUS GX



## TOYOTA LC



Model Year: **GX 460 - 2009 - 2013 -**

**LC 150 Diesel -  
2009 - 2013 - 2015 -**

**LC 150 Petrol - 2009 - 2013 -**

Vehicle Code: **URJ150L-GKTZKW**

**KDJ15\*L-G\*\*\*YW**

**GRJ150L-G\*\*\*KW**

Part Number:

Steel: PZ4AL-01927-00  
Aluminium: PZ4AL-01928-00



Weight:

Steel: 13,49 kg  
Aluminium: 8,91 kg



Installation Time:

40 min

PZ4AL-01927-00, PZ4AL-01928-00

**A**

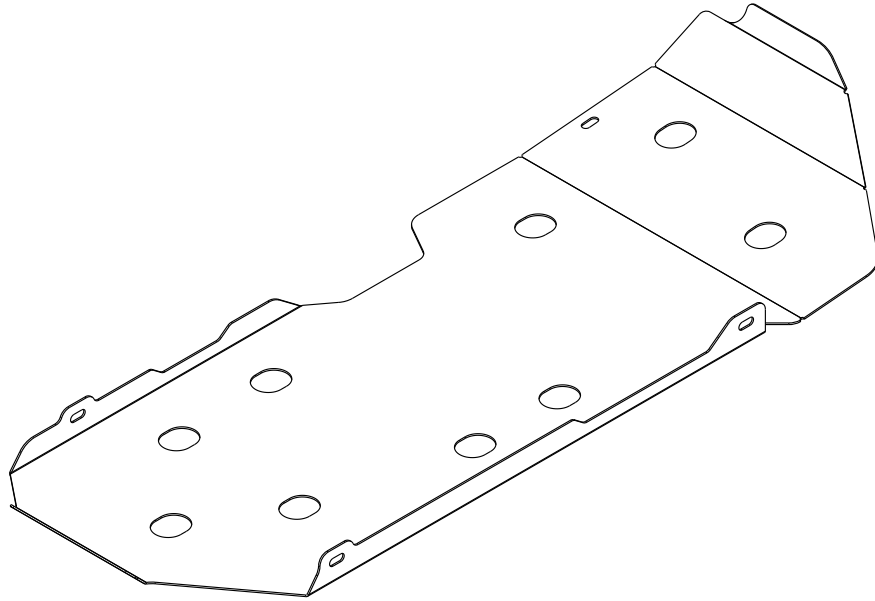

1x

PZ4AL-01927-60

**B1**

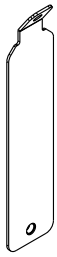

1x

**B2**

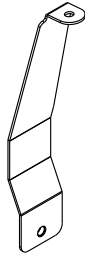

1x

**B3**

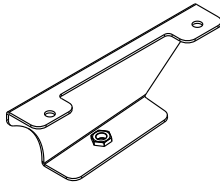

1x

**B4**



1x

**C**

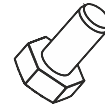

M10x20

4x

**D**

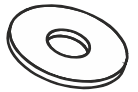

Ø 10

4x

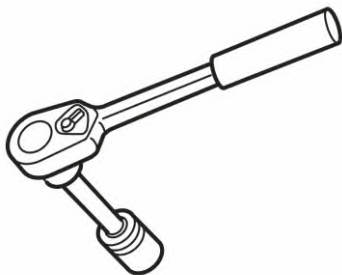

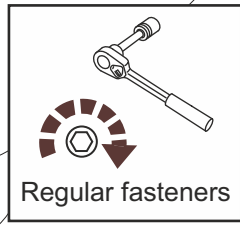
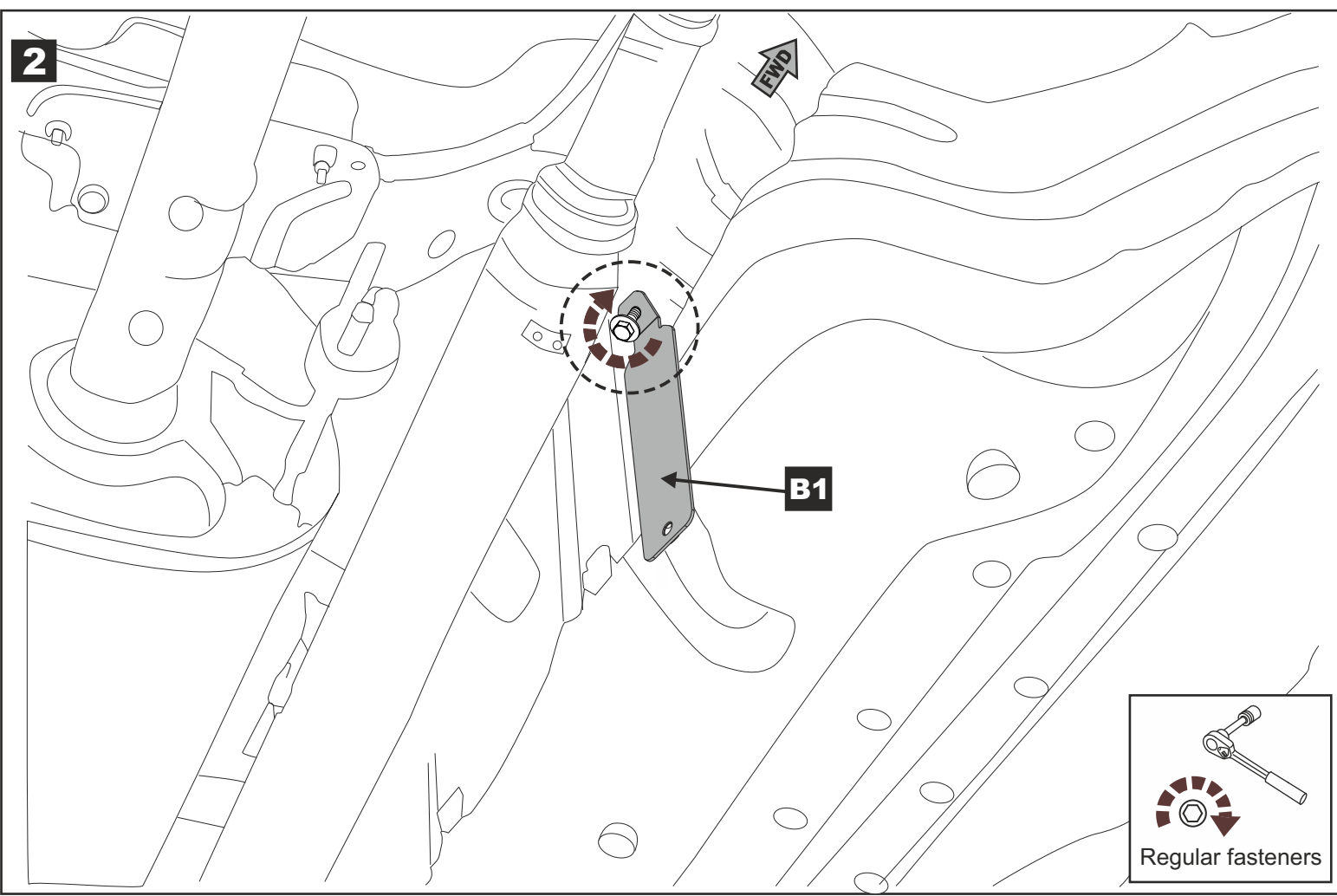
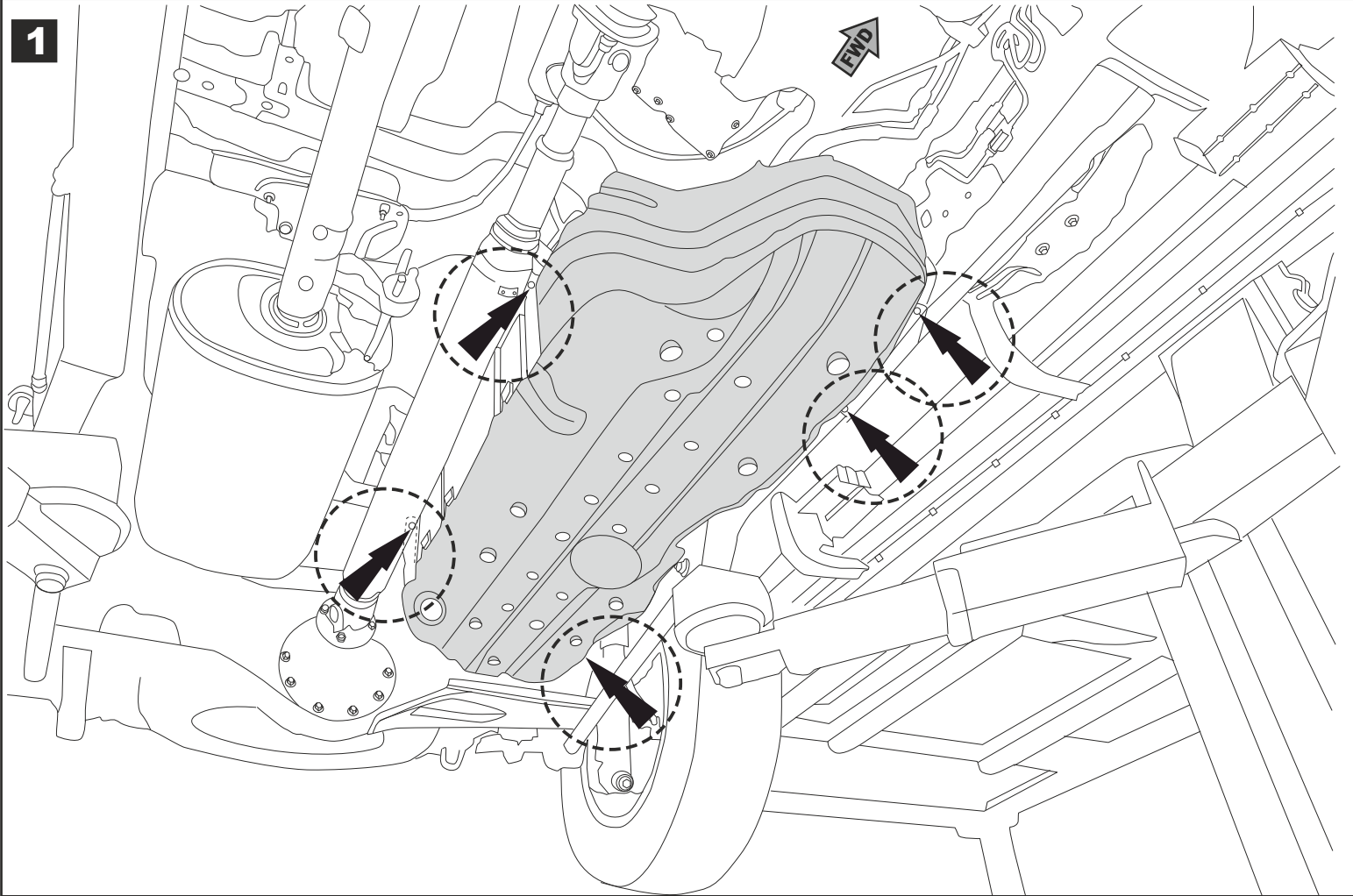

**3**

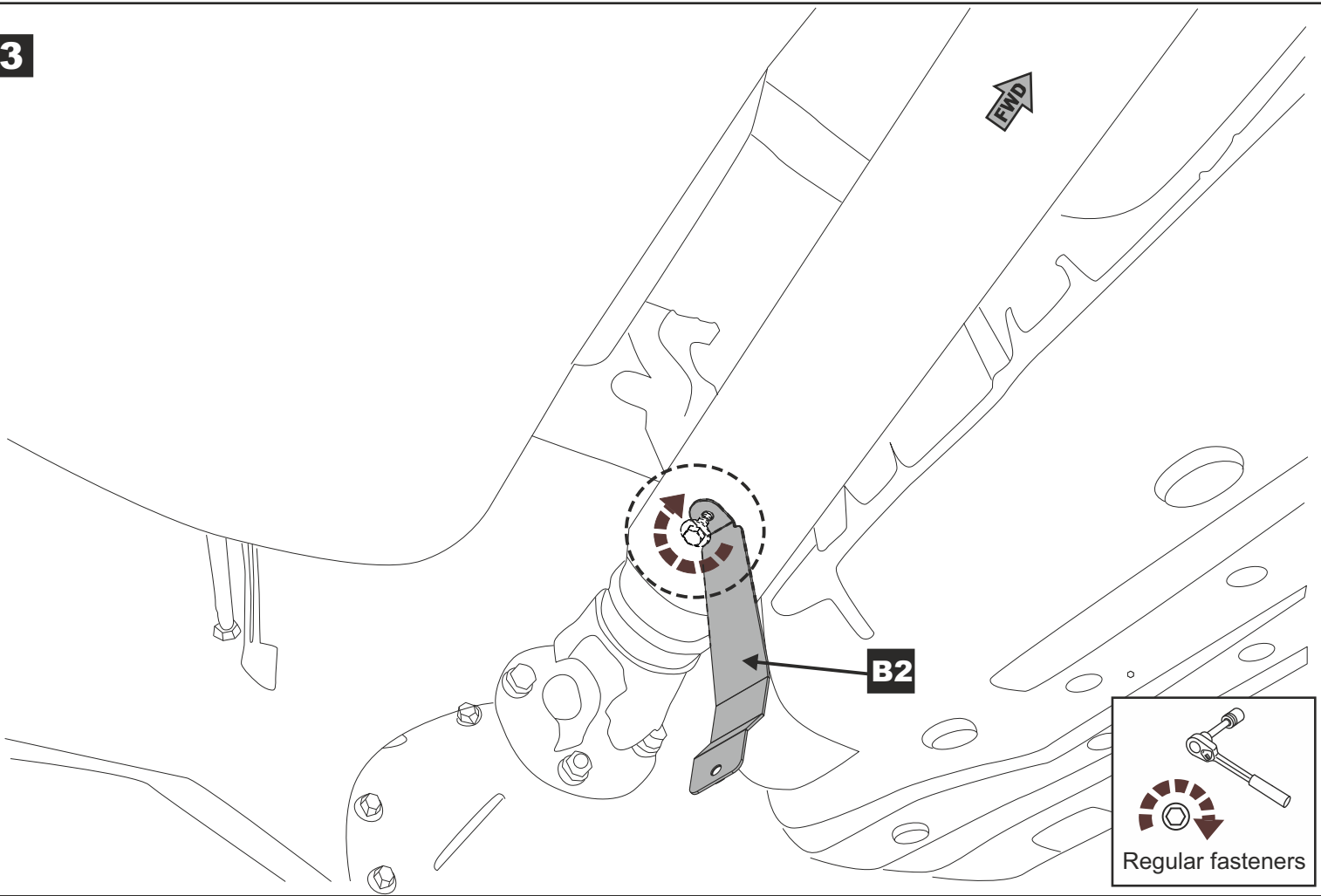

**4**

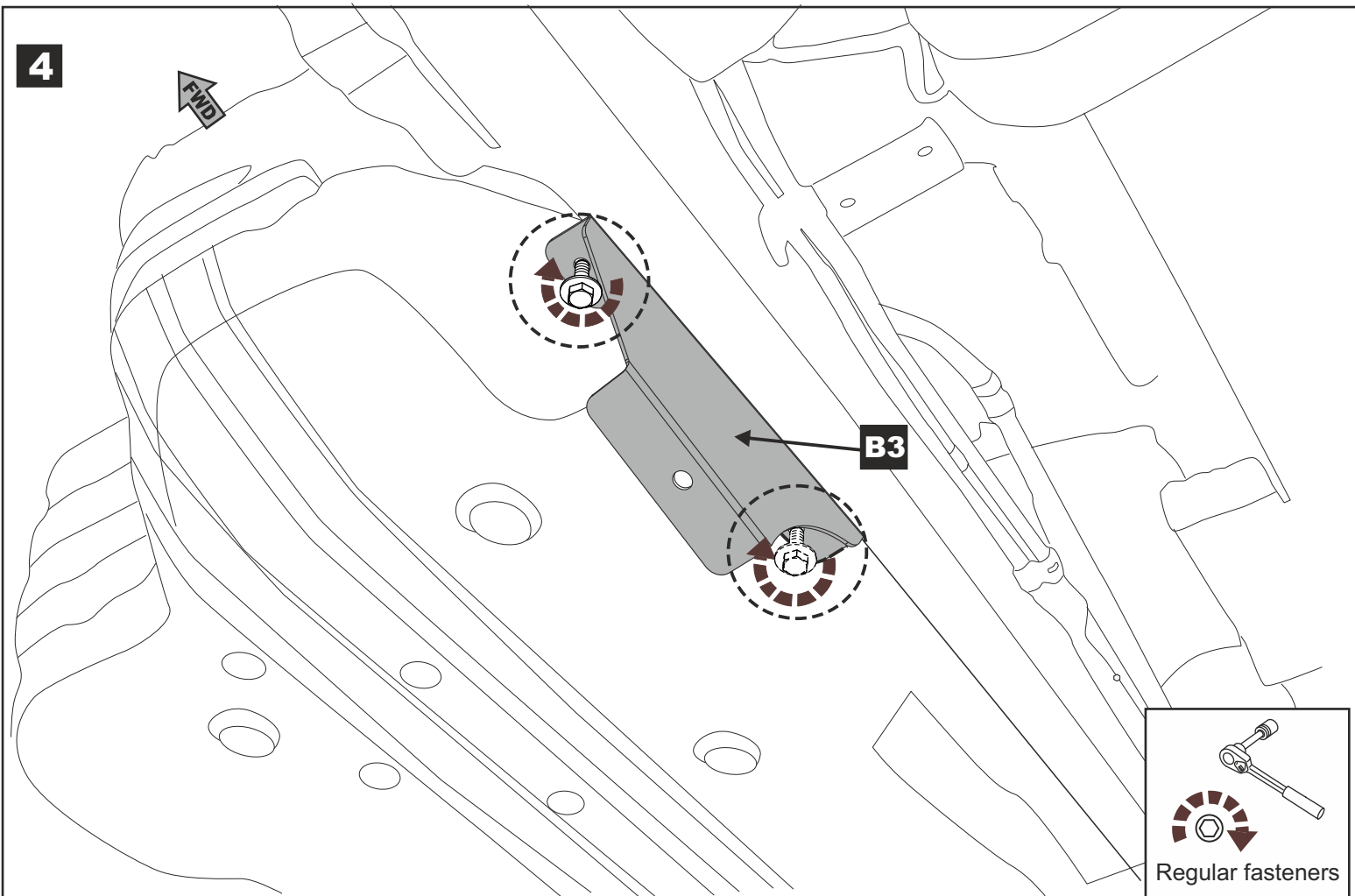

5

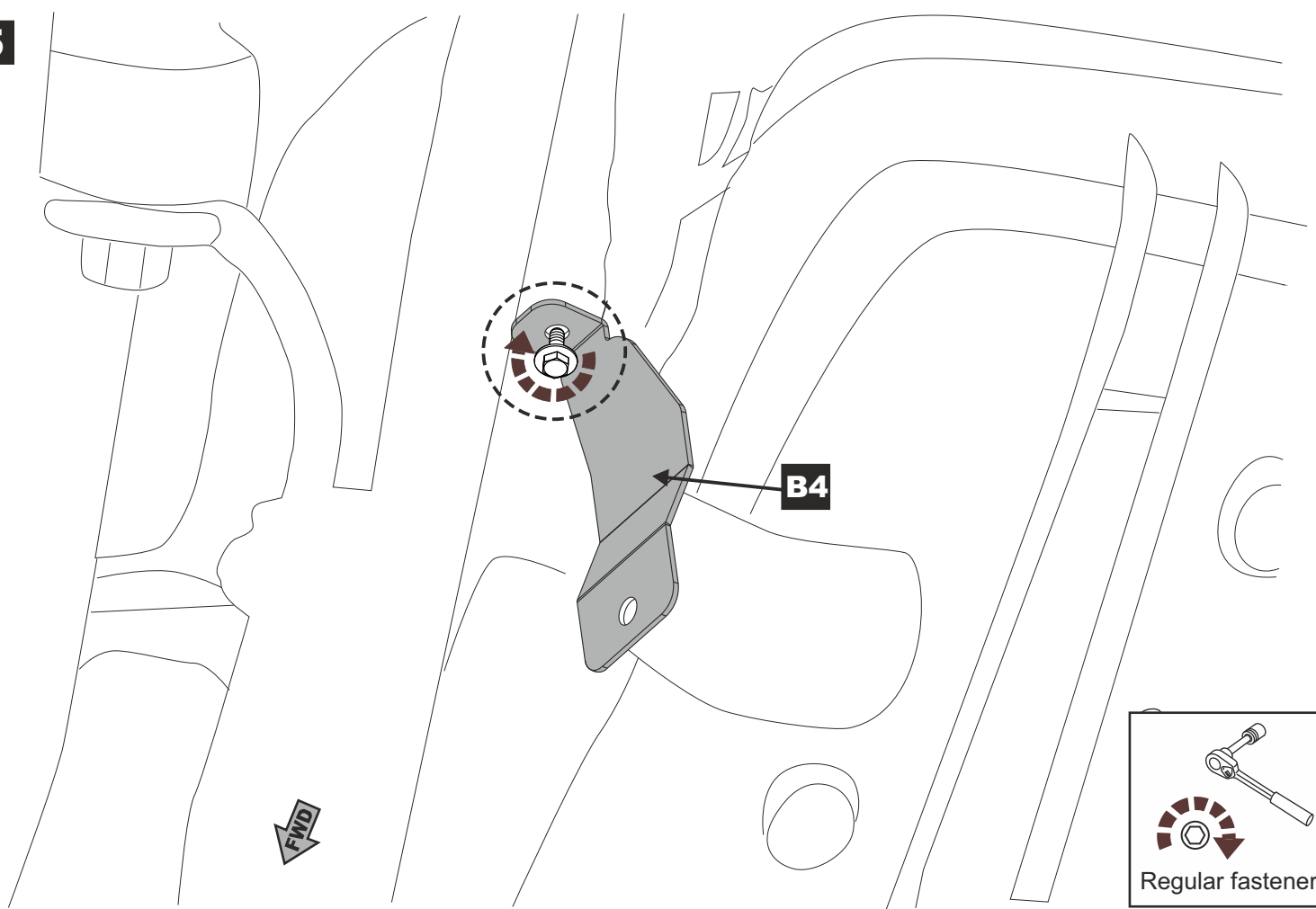

6

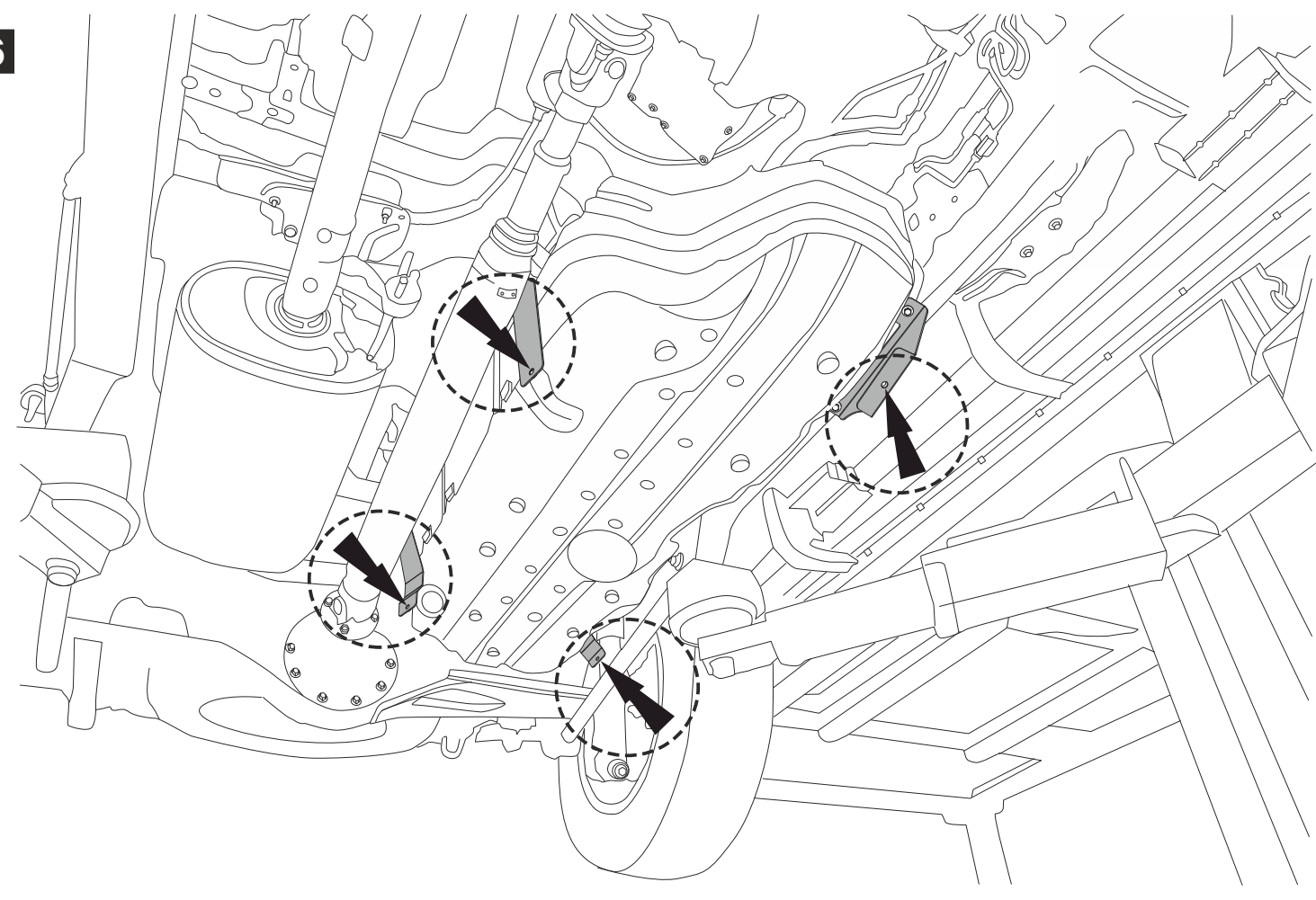



7

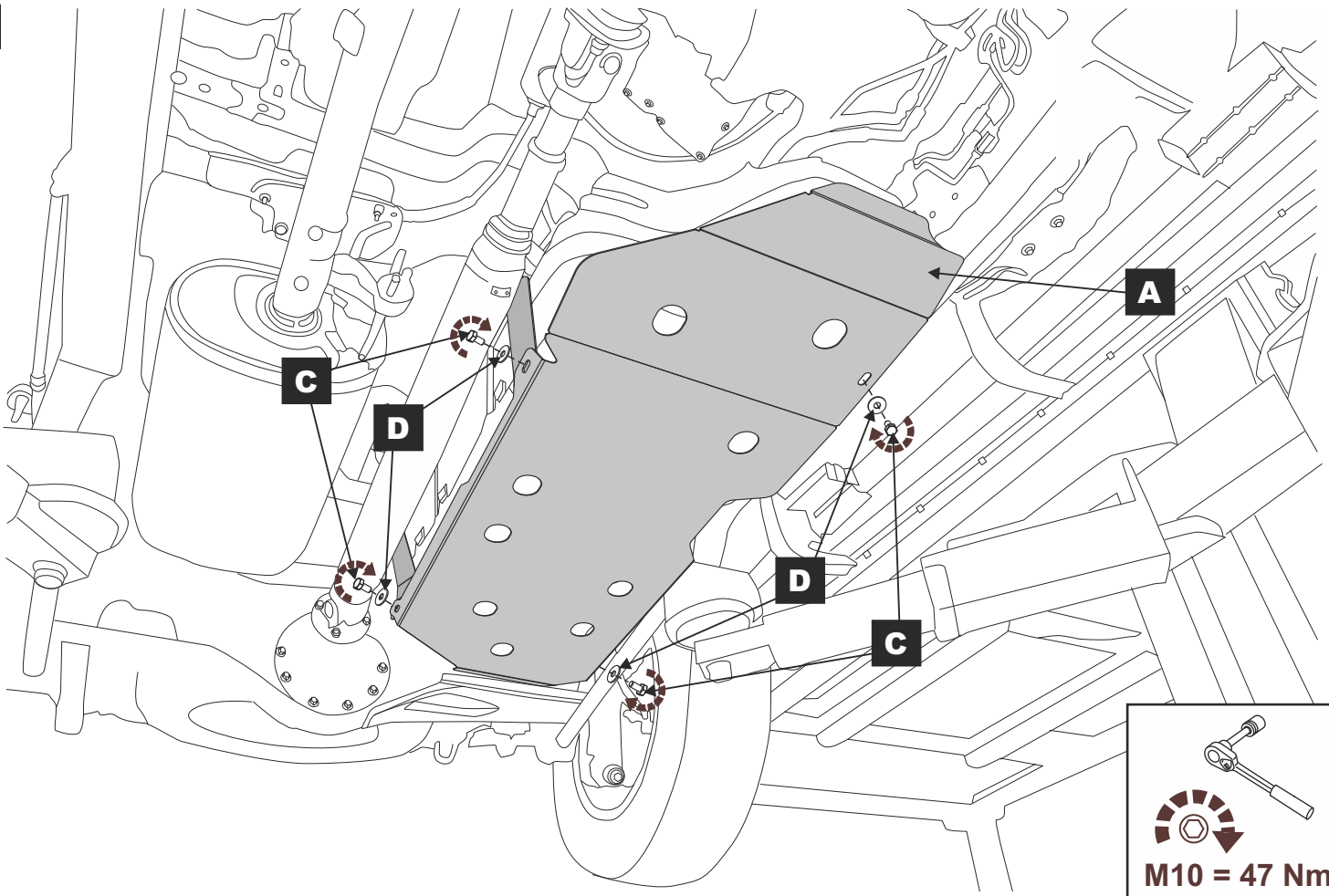

8

